

OKLAHOMA STATE UNIVERSITY INTERDISCIPLINARY SCIENCE RESEARCH BUILDING

The new facility will provide cutting edge, flexible laboratory space enabling interdisciplinary research among the physical and biological sciences in a high-tech environment that respects the OSU Stillwater campus. The interior of the building comprises the laboratories surrounded by collaborative spaces, offices for faculty and graduate students, and other support spaces.

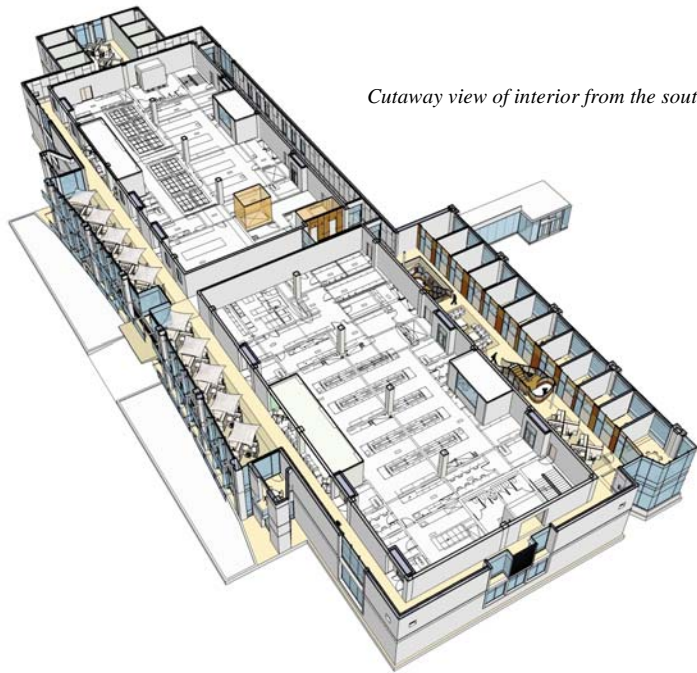

Cutaway view of interior from the southwest

Facility Fast Facts

- 124,000 square feet
- Cost - \$70 million
- Architects: Rees Associates of Oklahoma City in association with Cannon Design of Baltimore.
- Construction Manager: Flintco of Tulsa.
- First of an envisioned three-phase building program to build state-of-the-art research laboratories as part of the OSU Master Plan.
- Will contain custom-designed facilities for research in:
 - BioDiversity
 - Biophysics
 - Photonics
 - Synthetic Chemistry
 - Advanced Materials
- Other areas of research will be housed in the building as new programs emerge.
- Three floors above ground, plus a basement; connected to the existing Physical Sciences I building, which will undergo some renovation as part of the project.
- Designed for interdisciplinary interaction between faculty and students from multiple departments and colleges.
- Will contain laboratories, support facilities and infrastructure, meeting rooms and office space.
- “Signature” building will be a landmark project in OSU Campus Master Plan.
- Will draw the best and brightest to OSU from multiple fields in science and engineering to solve today’s complex problems.
- The project will serve as a cornerstone for innovation, collaboration and entrepreneurship as OSU grows its research programs and educates students in cutting-edge disciplines for the future of the state and the nation.

